

Fork Positioner (with Integral Sideshifter)

- **Function:** This attachment facilitates handling various size of loads easily and quickly by adjusting the fork distance hydraulically.
- **Application:** Various size of pallets and long loads handling.
- **Type:** non-side shifting, indendent arm moving, side shifting. (*Side shifting type is available with shaft type carriage only.)

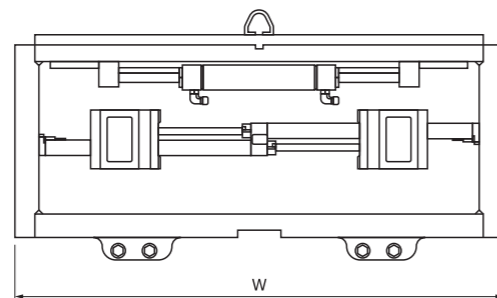

Model	Class	Width	Side shift	Capacity	ET	Fork Spread	HCG	Self Weight
		(mm)	(mm)	(kg)	(mm)	(mm)	(mm)	(kg)
FPS-2A 1040	II	1040	±100	2500	55	50-918	35	70
FPS-3A 1100	III	1100	±100	3500	63	50-975	36	85
FPS-4A 1535	IV	1535	±150	7000	94	80-1420	42	400
FPS-4A 1845	IV	1845	±150	7000	94	80-1730	42	485
FPS-5A 2200	V	2200	±150	10000	120	100-2100	60	920

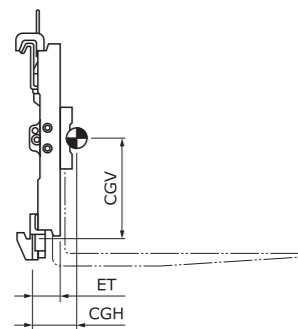

Class 2A, 3A

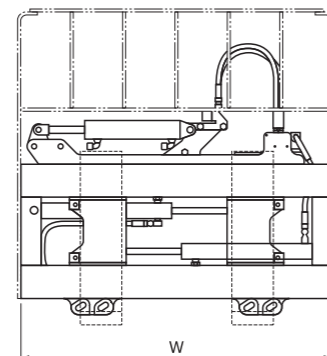
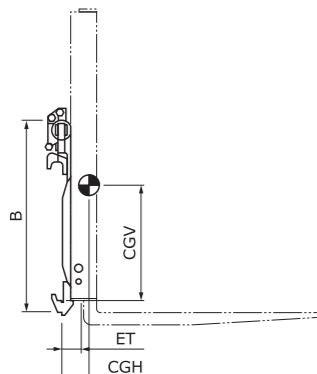

Class 4A

- 2 pieces of truck auxiliary valves are necessary. Working Pressure $\leq 180 \text{ kgf/cm}^2$.
Note: if ordered with remote control valve, only 1 piece of truck auxiliary valve requested!
- Big Range from 1ton to 10ton capacity, 800mm to 2400mm width, Class II to Class V.
- If not requested, positioners are shipped without the backrest holes.
- The positioner capacity is at 600mm load center.
- Fitting Screw M14×1.5 (2A, 3A), M18×1.5 (4A, 5A);
Recommended Hydraulic Pipe internal diameter 8mm (2A, 3A), 10mm (4A, 5A).



- High strength steel material.
- Robotic welding to ensure more stable and safer welding quality.
- Special two-step shot blast provides better surface and good finish.
- Dye penetrant test at the heel go guarantee no visual crack.
- Various types such as quality blank forks, shaft type forks and ISO forks are available.

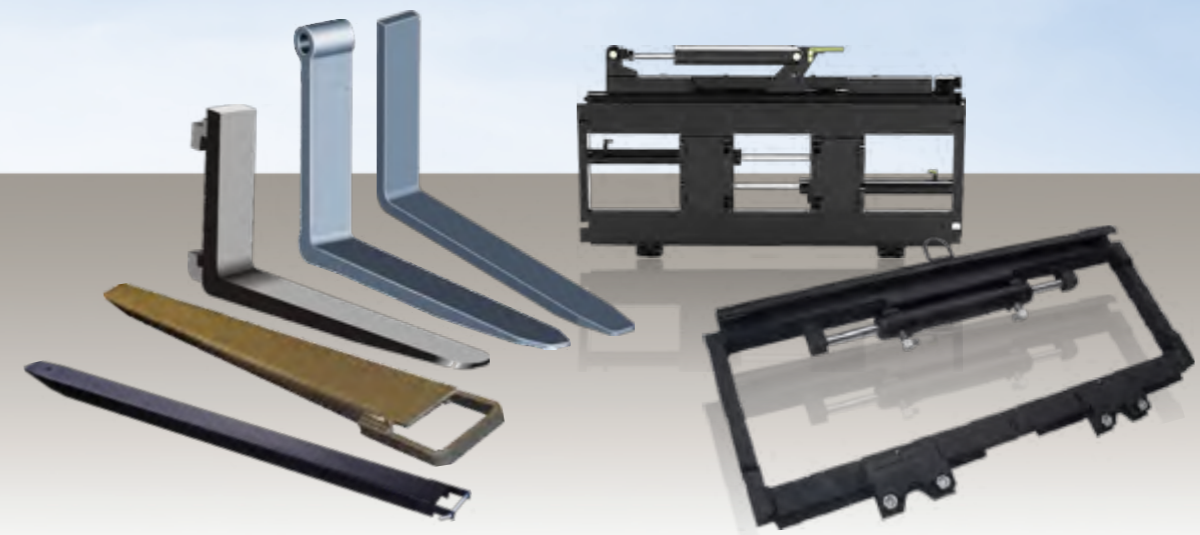

SINOLIFT MATERIAL HANDLING EQUIPMENT CORP.

ADD: 2477 Dachuan Road, Nanhui Industry Park, Shanghai 201300, P.R. China

TEL: +86 21 68014500 / +86 21 58003681

FAX: +86 21 68014262 / +86 21 68038190

EMAIL: info@sinolift.com

WEB: www.sinolift.com





HOOK FORKS

■ ISO, I.T.A, FEM standard forks: 2A, 2B, 3A, 3B, 4A, 4B up to 350mm width big forks!

ISO Standard	FORKS		CARRIAGE			
	M	K	A	B	C	D
Class A, B						
I	394	306	76	331	13	16
II	470	382	76	407	13	16
III	568	477	76	508	16	21.5
IV	743	598	127	635	19	25.5
V	830	680	127	728	25	34

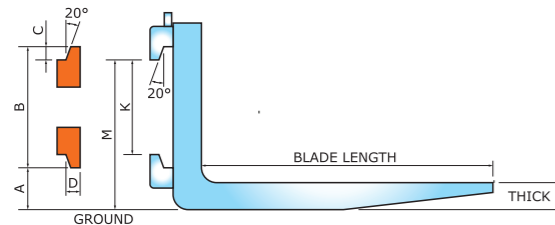

Traditional Hook/Latch I

Popular Hook/Latch II

Technical Data

Metric Market		
Model	Cross Section(mm)	Capacity*Load Center(kg*mm)
2A	80×40	1000*500
2A	100×35	1000*500
2A	100×40	1250*500
2A	100×45	1500*500
2A	100×50	1650*500
2A	120×35	1000*500
2A	120×40	1500*500
3A	120×45	1500*500
3A	120×50	2450*500
3A	125×40	1500*500
3A	125×45	2000*500
3A	125×50	2500*500
3A	130×40	1500*500
3A	130×45	2000*500
4A	150×50	2500*600
4A	150×60	3500*600
4A	150×65	4000*600
4A	150×70	4500*600
4A	150×75	5000*600

Inch Market		
Thickness×Width(inch)	Metric Size(mm)	Capacity*Load Center(kg*mm)
1½×3	80×40	850*600
1¾×4	100×35	850*600
1½×4	100×40	1150*600
1¾×4	100×45	1400*600
2×4	100×50	1750*600
1½×5	125×40	1400*600
1¾×5	125×45	1750*600
2×5	125×50	2150*600
2×6	150×50	2600*600
2¼×6	150×60	3750*600
2½×6	150×65	4400*600
2¾×6	150×70	5100*600
3×6	150×75	5850*600
2¾×8	200×70	4530*600
3½×8	200×90	7500*900
4×10	250×100	8675*1200
4×12	300×100	10425*1200
5×12	300×125	13575*1200
6×12	300×150	23425*1200

Remarks

Best Quality comes out from the Best QC process!

1. Only popular cross sections are listed above. We can produce up to 320mm×140mm!
2. The max. length we make is 3800mm and max. back height is 1400mm.
3. Raw Material: We strictly pick out the Cr40 Alloy Steel rolled by 6:1 proportion and forged by 3:1 proportion. Smooth/good shape of raw steel is critically important for final products.
4. Machine/equipment Guarantee 80% equipments are automatically/digital control.

5. Experienced technicians and workers with regular training.
6. ISO 2328 and ISO2330 standard production process with strict 24 hours heat-treatment. Hardness testing HB250-361. Strict couple making.
7. 3 times static overload testing; 1.5times dynamic overload testing; 1 million times of fatigue/yield testing!
8. Market is always the best teacher of quality! Our world wide sale can show the quality confidence!

Generally, good forks means not only safety but also good fitting and good looking!

SHAFT FORKS

■ Pin-type (shaft-mounted) Quality Forks

- Pin-Type forks are guided on a shaft.
- The dimensions are not standardized. SINOLIFT is producing a wide variety of pin-type forks which are individually designed to customer's requirement.
- Mostly pin-type forks are used for larger lift trucks or for construction machines.

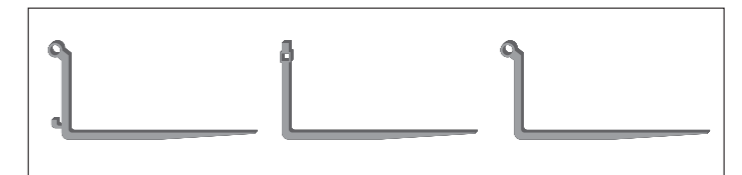
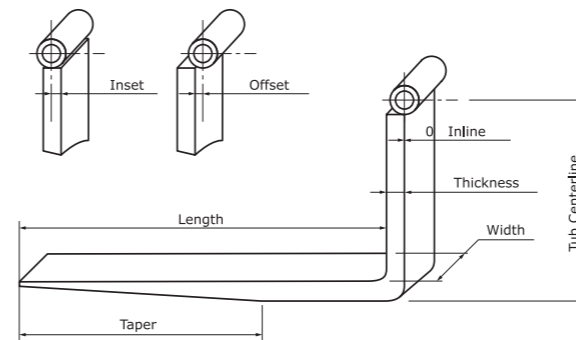
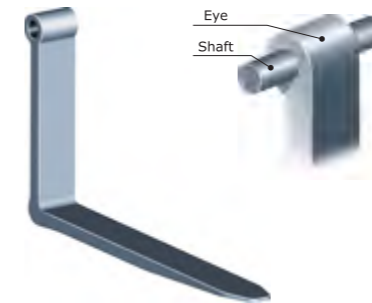

Special fork keepers available

Most common versions:

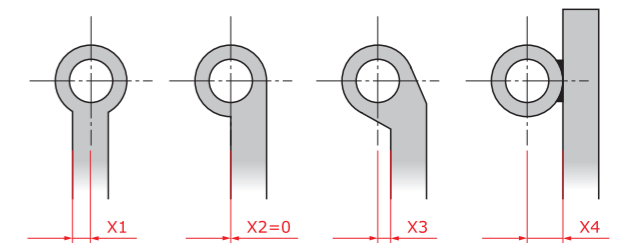

Technical Data

Fork Cross Section T×W(inch)	Fork Cross Section T×W(mm)	Capacity/pair Kg@600mm	Capacity/pair Kg@900mm	Capacity/pair Kg@1200mm
1¼×4	35×100	1700	1150	850
1½×3	40×80	1700	1150	850
1¼×4	40×100	2500	1650	1250
1¼×5	40×122	2700	1800	1350
1¼×6	40×150	3300	2200	1650
1¼×7	40×180	4000	2650	2000
1¼×8	40×200	4400	2950	2200
1¾×4	45×100	2800	1850	1400
1¾×4½	45×115	3200	2150	1600
1¾×5	45×112	3400	2250	1700
1¾×7	45×180	5000	3350	2500
2×4	50×100	3500	2350	1750
2×5	50×122	4200	2850	2100
2×6	50×150	5200	3450	2600
2×7	50×180	6300	4200	3150
2×8	50×200	6900	4600	3450
2¼×4	60×100	5050	3350	2525
2¼×5	60×122	6300	4200	3150
2¼×6	60×150	7500	5000	3750

Fork Cross Section T×W(inch)	Fork Cross Section T×W(mm)	Capacity/pair Kg@600mm	Capacity/pair Kg@900mm	Capacity/pair Kg@1200mm
2¼×7	60×180	9000	6000	4500
2¼×8	60×200	10000	6650	5000
2½×5	65×122	7300	4850	3650
2½×6	65×150	8800	5850	4400
2½×7	65×180	10500	7000	5250
2½×8	65×200	11700	7800	5850
2¾×6	70×150	10200	6800	5100
2¾×7	70×180	12200	8150	6100
2¾×8	70×200	13600	9060	6800
3×6	75×150	11700	7800	5850
3×7	75×180	14100	9400	7050
3×8	75×200	15600	10400	7800
3½×8	90×200	22500	15000	11250
3¾×8	95×200	25100	16750	12550
4×10	100×250	34700	23150	17350
4½×12	115×300	55050	36700	27525
5½×12	140×300	81600	54400	40800
6×12	150×300	93700	62450	46850



FORKS EXTENSION

- Any size of fork extension is available.
- Very reasonable design lock pin!

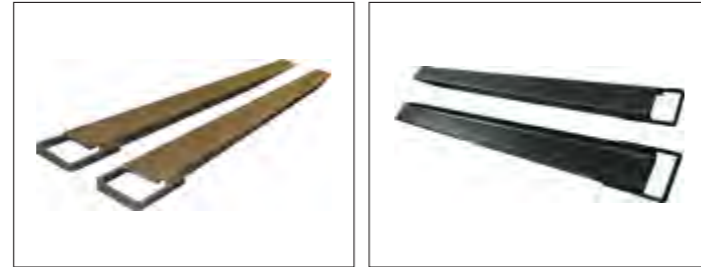
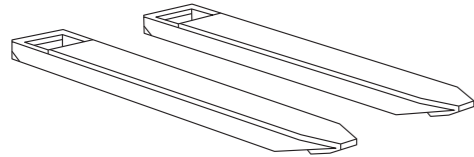

Yellow, red and other color is available.

Technical Data

Model	Class	Max. Fork Selection	Length
EXI 1200	Class I	mm 100x45	1200
EXI 1500	Class I	mm 100x45	1500
EXI 1800	Class I	mm 100x45	1800
EXI 2000	Class I	mm 100x45	2000
EXI 2200	Class I	mm 100x45	2200
EXI 2400	Class I	mm 100x45	2400
EXII 1500	Class II	mm 125x45	1500
EXII 1800	Class II	mm 125x45	1800
EXII 2000	Class II	mm 125x45	2000
EXII 2200	Class II	mm 125x45	2200
EXII 2400	Class II	mm 125x45	2400
EXIII 1500	Class III	mm 150x50	1500
EXIII 1800	Class III	mm 150x50	1800
EXIII 2000	Class III	mm 150x50	2000
EXIII 2200	Class III	mm 150x50	2200
EXIII 2400	Class III	mm 150x50	2400
EXIII 3000	Class III	mm 150x50	3000
EXIV 1800	Class IV	mm 180x75	1800
EXIV 2000	Class IV	mm 180x75	2000
EXIV 2200	Class IV	mm 180x75	2200
EXIV 2400	Class IV	mm 180x75	2400
EXIV 3000	Class IV	mm 180x75	3000
EXIV 4000	Class IV	mm 180x75	4000

Cautions

- Contact the manufacturer of your forklift for written approval for the use of any fork lift attachments.
- Fork extension do not exceed length of forks on which they are installed by more than 50%.
- Capacity is based on length of your fork tine.
- For each 25mm(1") of extension beyond fork, reduce capacity by:
 - 77kg(170lbs) per 25mm(1") on 2000kg(4500lbs) forklift.
 - 73kg(160lbs) per 25mm(1") on 2300kg(5000lbs) forklift.
 - 70kg(155lbs) per 25mm(1") on 2500kg(5500lbs) forklift.

Carpet Booms II

Length mm	Part #	Weight(Ø65) kg
2400	90005	124
2700	90010	142
3000	90015	150
3300	90020	159
3600	90020	167

Capacity(kg@1500mm): 540kg
 Safety Capacity: 2.5:1
 Add 20% for Class III

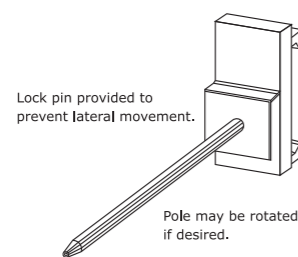

Folding Forks II

Size(TxMxL) mm	Part #	Weight kg/Each
32*100*850	F1010	32
32*100*920	F1011	36
32*100*1070	F1012	40
32*100*1220	F1013	44
35*100*850	F1510	34
35*100*920	F1511	39
35*100*1070	F1512	43
35*100*1220	F1513	48

Safety Capacity: 2.5:1
 Class II only

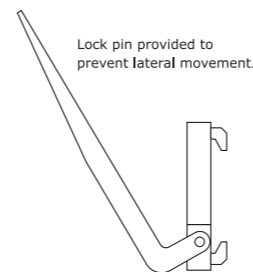

ORDER REQUEST SHEETS

ISO / FEM / I.T.A Hook Forks.

Distance Between Hooks	Mounting Class	Carriage Height	Check Your Choice
M 306	I	331	<input type="checkbox"/>
M382	II	407	<input type="checkbox"/>
M477	III	508	<input type="checkbox"/>
M598	IV	635	<input type="checkbox"/>

T-----Thickness
 W-----Width
 L-----Length

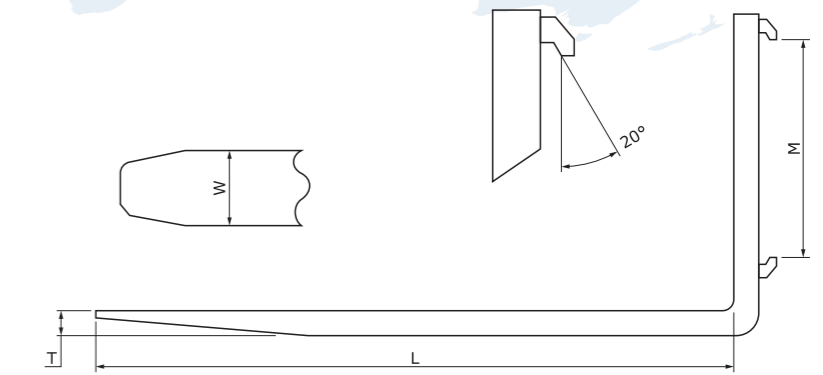

Square Hook Forks

Q= _____ A= _____ L= _____
 R= _____ B= _____ H= _____
 S= _____ C= _____ Z= _____
 V= _____ D= _____
 T= _____ E= _____
 W= _____

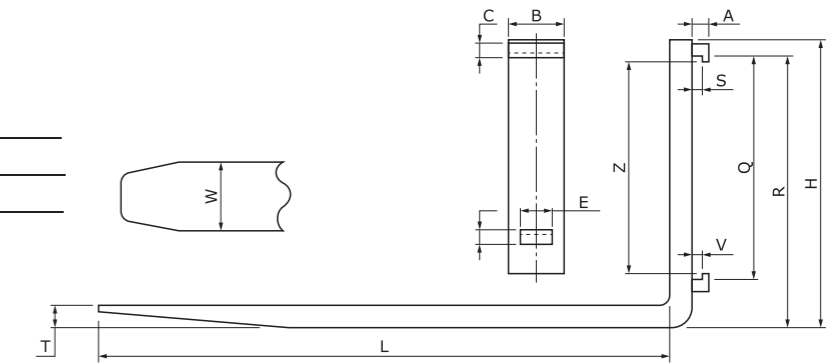

Pin Type Forks

H= _____ to the Center of Tube
 B= _____ Inset
 C= _____ Offset } Choose One Style Only
 D= _____ Inline
 T= _____ Thickness
 W= _____ Width
 L= _____ Length
 OD= _____ Outside Diameter
 ID= _____ Inside Diameter
 SD= _____ Pin Diameter Carriage

Note: Please indicate if locking slot or lubrication hole on the tube is requested.

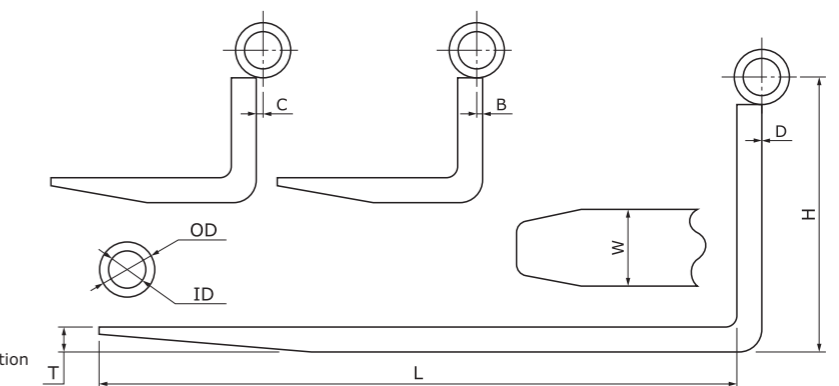

Blank Forks

T= _____ Thickness
 W= _____ Width
 H= _____ Height
 L= _____ Length

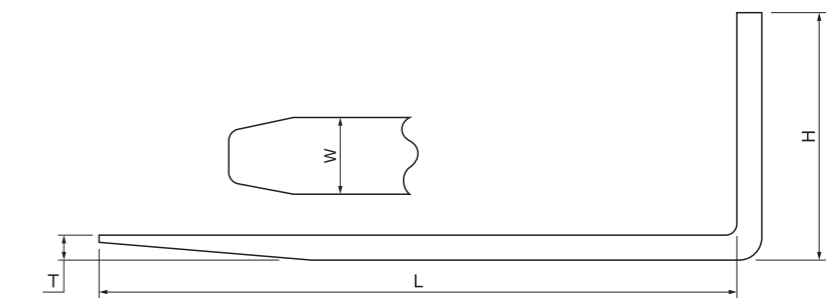



TECHNOLOGY & GERNERAL STANDARD

1. Material: refer to below list

- 1) Fork bodies: 35Cr, 15B37, 33MnCrTiB; 2) Fork bodies: 20Cr; 3) Tube: 20#

Material No.	C%	Si%	Mn%	Cr%
35Cr	0.32-0.39	0.17-0.37	0.50-0.80	0.80-1.10
15B37	0.30-0.35	0.15-0.35	1.25-1.50	0.30-.060
33MnCrTiB	0.30-0.35	0.15-0.35	1.25-1.50	0.30-.060
20Cr	0.17-0.24	0.17-0.37	0.50-0.80	0.70-1.0
20#	0.17-0.24	0.17-0.37	0.35-0.65	0.25

2. Welding: JFE solid wire with CO2 protection

3. Machinery capacity:

- 1) Yield point: $\sigma_b=784$ Mpa (Min.)
- 2) Tensile stress: $\sigma_s=931$ Mpa (Min.) Impact: $I=27J$ min(-20° C-V)
- 3) Surface hardness: HB285-363; Hardness must be inspected for every fork after Heat treatment.

4. Magnaglo must be done for every fork after shot blasting.

5. Producing standard: ISO2328

6. Inspecting standard: ISO2330; ISO683-1

7. Stamping on one side of shank, including:

- 1) Loading capacity: kg×LC(mm)
- 2) Material heat number
- 3) Mnaufacturing date and lot number

8. Painting: anti-rust (red color) first, and coating with users required color.

9. Assembly: our design as right figure:

10. Packing: with wooden pallet with fork weight less than 2500Kg per.

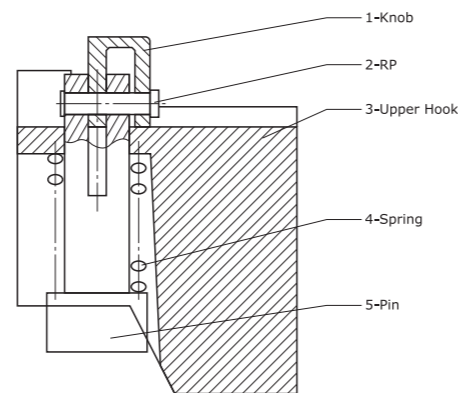

SPERCIAL FORKS

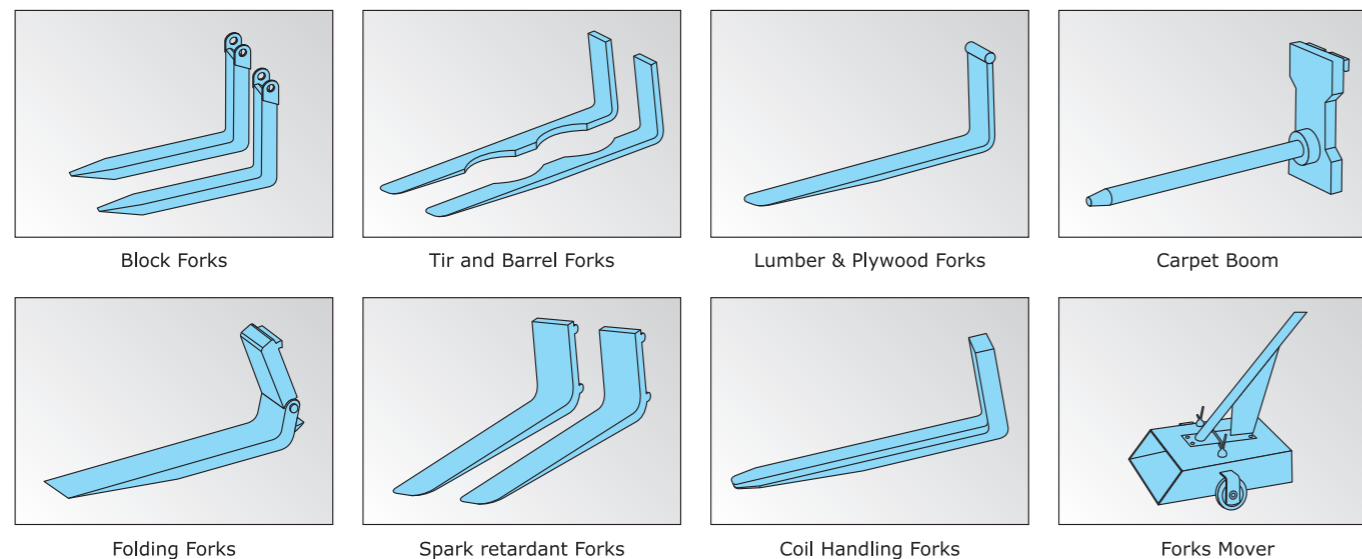

Note:

Basing on our strong machining ability and knowledge, we are able to produce any kinds of forks or related accessories (like Carriage Bars, Backrest etc.) for different application. Please pass your drawing request to: sinolift@sinolift.com

SHIDESHIFTER

SINOLIFT Sideshifters comply with Industrial Truck Association (ITA) and International Standard Organization (ISO) standards.

- **Application:** Shift a load from side to side for reduced handling time and improved maneuverability. Excellent specifications optimize truck capacity.
- **Options:** Narrow-Aisle Sideshifter; Quick Disconnect Mounting; Bronze Upper Bearing; Various Sideshifter Strokes.



Hang-On Sideshifter



Integral Sideshifter

Model	Class	Frame Width	Capacity	Side Shift	ET	CGH	Self Weight
		(mm)	(kg)	(mm)	(mm)	(mm)	(kg)
SS-AA980	II	980	1800	±100	61	28	54
SS-2A1040	II	1040	2500	±100	61	28	56
SS-3A1100	III	1100	3500	±100	67	32	76
SS-3A1250S	III	1250	5000	±100	82	36	120
SS-4A1535	IV	1535	7000	±150	94	42	215
SS-4A1845	IV	1845	7000	±150	94	42	325

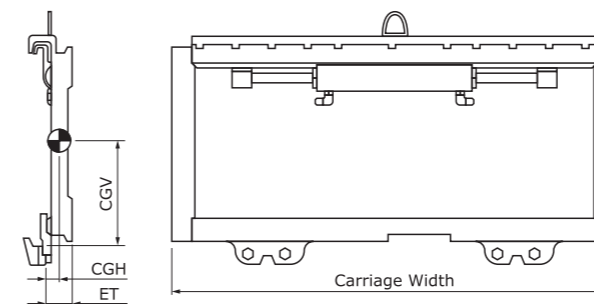

2A,3A Sideshifter

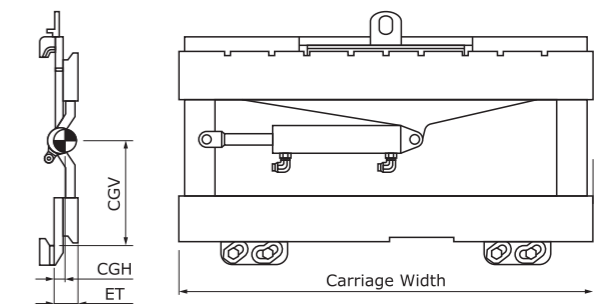

4A Sideshifter

1. **Big Range** from 1ton to 10ton capacity, 800mm to 2400mm width, Class II to Class V.
2. 2A-3A Frame is made of Cold Extrusion Bar to ensure better finish and strength.
3. 30% overload testing with 3 times moving speed to qualify the heavy-duty and impacting ability.
4. 20,000 times shifting test with overload pressure to prove **Non-leakage** sealability.
5. High durability nylon pads with oil nipples and slots offer smooth move and long time use.
6. Very competitive cylinder, seal kits and nylon pads to save much service cost.
7. Frame width available from 800mm to 1750mm for 2A, 3A and 2400mm for 4A!
8. 1 piece of truck auxiliary valve is necessary. Working Pressure ≤ 160 kgf/cm³.
9. If not requested, sideshifters are shipped **without** the backrest holes.
10. The side shifter capacity is at 600mm load center.
11. Fitting Screw M14×1.5 (2A, 3A), M18×1.5 (4A, 5A);
Recommended Hydraulic Pipe internal diameter 8mm.